

Catenaccio mod. 454 Barrel bolt mod. 454

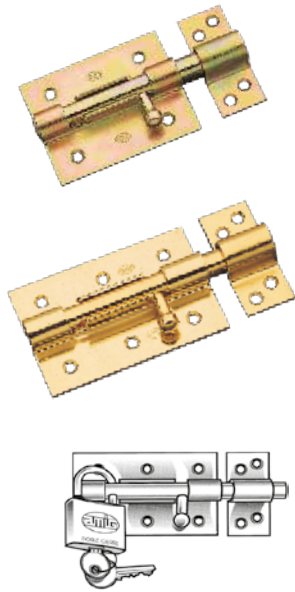

Finitura Finish	Misure mm (A) Sizes mm.	Cod.	
Bicromato Bichromated	70	10746	5 50
	85	10747	5 40
	100	10748	5 50
	120	10779	5 40
Ottonato verniciato Brass plated varnished	70	14088	5 50
	85	14089	5 40
	100	14090	5 50
	120	14091	5 40
Nero Black	70	22351	5 50
	85	22352	5 40
	100	22353	5 50
	120	22354	5 40
Acciaio inossidabile 18/8 Stainless steel AISI 304	70	14176	5 50
	85	14177	5 40
	100	14178	5 50
	120	14179	5 40

Supporto con 4 fori
Support with 4 holes

Con foro \varnothing 8 portalucchetto
With padlock hole \varnothing 8 in bar

 Con lucchetto
With padlock

A (mm)	70	85	100	120
B (mm)	67	67	67	67
\varnothing C (mm)	104	126	146	184
\varnothing D (mm)	13	13	13	15
	4	4	6	6

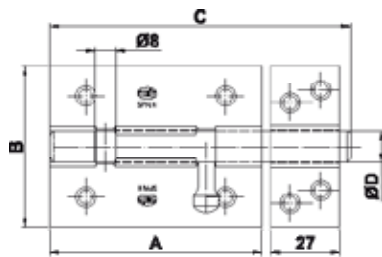

Catenaccio mod. 464 Barrel bolt mod. 464

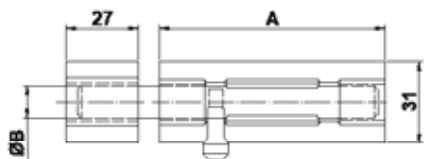

A(mm)	70	85	100	120
\varnothing B	13	13	13	15

Finitura Finish	Misure mm Sizes mm.	Cod.	
Bicromato Bichromated	70	14092	5 50
	85	14093	5 40
	100	14094	5 50
	120	14095	5 40

Per saldare
For welding

Con foro \varnothing 8 portalucchetto
With padlock hole \varnothing 8 in bar

Catenaccio mod. 383 Barrel bolt mod. 383

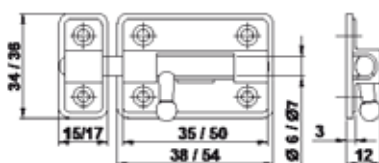
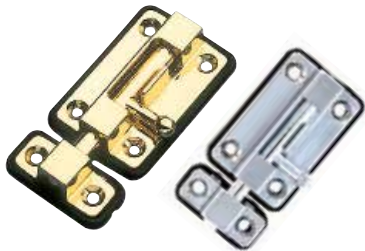

Finitura Finish	Misure mm Sizes mm.	Cod.	
Cromato brillante Chrome plated	35	6337	20 400
	50	6339	20 300
Ottonato verniciato Brass plated varnished	35	6338	20 400
	50	6340	20 300
Bianco White	35	19505	20 400
	50	19506	20 300

Catenaccio mod. 384 Barrel bolt mod. 384

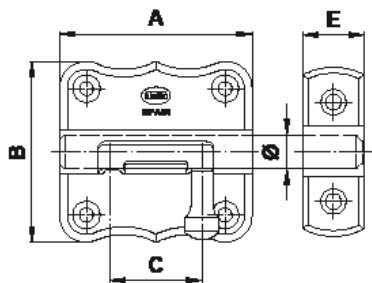

Finitura Finish	Misure mm (A) Sizes mm.	Cod.			
Ottonato verniciato Brass plated varnished	30	527	20	500	
	35	516	20	400	
	40	517	20	300	
	50	519	20	200	
	60	520	20	160	
Nichelato Nickel plated	30	227	20	500	
	35	230	20	400	
	40	233	20	300	
	50	239	20	200	
	60	242	20	160	
	70	245	10	80	
	85	248	10	60	
Zincato Zinc plated	30	228	20	500	
	35	231	20	400	
	40	234	20	300	
	50	240	20	200	
	60	243	20	160	
	70	246	10	80	
	85	249	10	60	
Acciaio inossidabile Stainless steel	40	235	20	300	
	50	241	20	200	
	60	244	20	160	
	70	247	10	80	
	85	250	10	60	
Nero Black	40	235	20	300	
	50	241	20	200	
	60	244	20	160	
	70	247	10	80	
	85	250	10	60	

Cod.			
7250	20	300	
7251	20	300	
7252	20	300	
7253	20	200	
7254	20	200	

	A	B	C	Ø	E	⊕
25 mm	25	33	11	6,5	11	4
30 mm	30	33	14	6,5	13	4
35 mm	35	33	17	6,5	13	4
40 mm	40	38	19	7,5	14	4
50 mm	50	48	24	9	16	4
60 mm	60	48	31	9	16	6
70 mm	70	56	35	12	25	6
85 mm	85	56	45	12	25	6
100 mm	100	56	50	12	25	6

Catenacci
Barrel bolts

Catenaccio mod. 390 Barrel bolt mod. 390

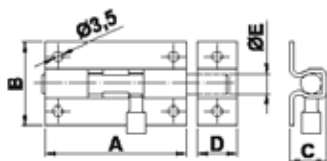
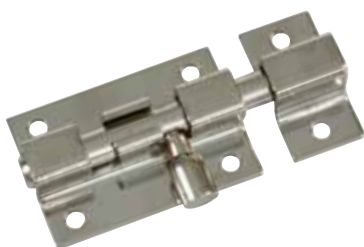

A	B	C	D	ØE
30	27,5	10,8	14	6,5
40	27,5	10,8	14	6,5
50	29,5	13,0	16	7,5
60	29,5	13,0	16	7,5

Finitura Finish	Misure mm Sizes mm.	Cod.			
Ottonato verniciato Brass plated varnished	30	392	20	500	
	40	396	20	300	
	50	399	20	300	
	60	402	20	200	
Nichelato Nickel plated	30	380	20	500	
	40	383	20	300	
	50	386	20	300	
	60	389	20	200	

Catenaccio mod. 391-392 Barrel bolt mod. 391-392



Ref.	A	B	C
40	38	12,5	15
50	51	12,5	15
60	63	15,5	20
80	76	15,5	20
100	101	15,5	20
120	127	15,5	20
150	152	15,5	20

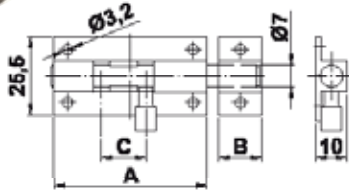

Mod. Mod.	Finitura Finish	Misure mm Sizes mm.	Cod.			
391	Ottone lucido verniciato Solid brass varnished	40	1356	20	200	
		50	1357	20	200	
		60	1358	20	200	
		80	6397	20	200	
		100	6398	10	100	
		120	6399	10	100	
392	Ottone cromato brillante Nickel plated brass	40	4596	20	200	
		50	4597	20	200	
		60	4598	20	200	
		80	6401	20	200	
		100	6402	10	100	
		120	6403	10	100	
150	6404	10	100			

Catenaccio alluminio mod. 500 Aluminium barrel bolt mod. 500

CORPO DI ALLUMINIO, CATENACCIO CORPO BICROMATO
BODY IN ALUMINIUM, BOLT IN STEEL BICHROMATED

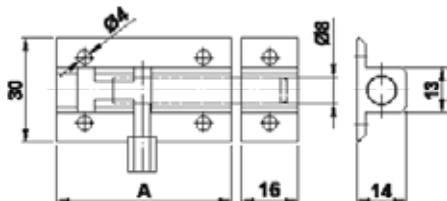

Finitura Finish	Misure mm (A) Sizes mm.	Cod.			
Laccato bianco White painted	50	758	20	200	
	60	759	20	200	
	80	760	20	200	
	100	761	20	200	
	120	762	20	100	
	150	763	20	100	
	200	764	10	50	
	250	768	10	50	
Anodizzato bronzo Bronze anodized	50	770	20	200	
	60	771	20	200	
	80	772	20	200	
	100	773	20	200	
	120	774	20	100	
	150	775	20	100	
Laccato nero Black painted	50	869	20	200	
	60	870	20	200	
	80	871	20	200	
	100	893	20	200	
	120	894	20	100	
	150	895	20	100	
	200	896	10	50	
	250	897	10	50	
Anodizzato oro Gold anodized	50	838	20	200	
	60	839	20	200	
	80	840	20	200	
	100	841	20	200	
	120	899	20	100	
	150	971	20	100	
	200	972	10	50	
	250	973	10	50	
Anodizzato argento Silver anodized	50	975	20	200	
	60	976	20	200	
	80	977	20	200	
	100	983	20	200	
	120	984	20	100	
	150	985	20	100	
	200	986	10	50	
	250	987	10	50	
300	988	10	50		

Catenaccio alluminio mod. 500 *Aluminium barrel bolt mod. 500*

CORPO DI ALLUMINIO, CATENACCIO ACCIAIO INOSSIDABILE
BODY IN ALUMINIUM, BOLT IN STAINLESS STEEL



Finitura Finish	Misure mm Sizes mm.	Cod.		
Laccato bianco <i>White painted</i>	80	20292	10	100
Anodizzato oro <i>Gold anodized</i>	80	20293	10	100
Anodizzato argento <i>Silver anodized</i>	80	20294	10	100

Catenaccio mod. 720 *Barrel bolt mod. 720*

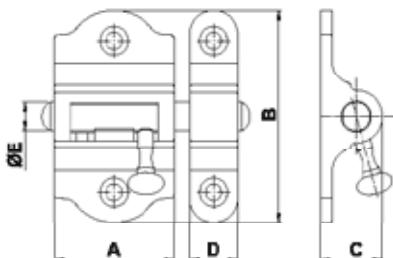

	A	B	C	D	ØE	
25 mm	25	46	15.5	10	7	2
30 mm	30	53	15.5	12	7	2
40 mm	40	70	18	16	8	4
50 mm	50	88	18	20	8	4



Finitura Finish	Misure mm (A) Sizes mm.	Cod.		
Ottonecromato opaco	25	8795	10	100
Satin nickel brass	30	8796	10	100
	40	8797	5	50
	50	8798	5	50
Ottone lucido verniciato	25	8807	10	100
Solid brass varnished	30	8808	10	100
	40	8809	5	50
	50	8810	5	50

Catenaccio mod. 721 Barrel bolt mod. 721

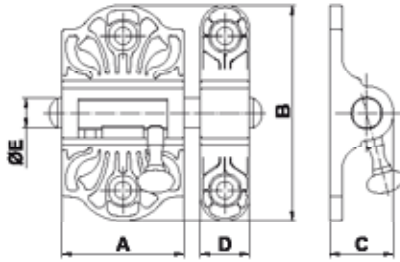

↗	A	B	C	D	ØE	⊕
25 mm	25	46	15.5	10	7	2
30 mm	30	53	15.5	12	7	2
40 mm	40	70	18	16	8	4
50 mm	50	88	18	20	8	4

Finitura Finish	Misure mm (A) Sizes mm.	Cod.		
Ottone opaco	25	8811	10	100
Satin brass	30	8812	10	100
	40	8813	5	50
	50	8814	5	50

Catenaccio mod. 388 Barrel bolt mod. 388

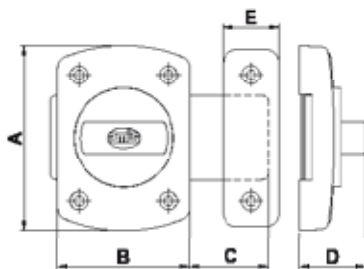

↗	A	B	C	D	E
30 mm	42	30	14	23	11
40 mm	56	40	23	24	16,5
50 mm	70	50	30	25	21

Misure mm Sizes mm.	Finitura Finish	Cod.		
30	Bianco White	8997	20	120
	Cromato brillante Chrome plated	4723	20	120
	Ottonato verniciato Brass plated varnished	4724	20	120
	Nichel spazzolato Brushed nickel	5730	20	120
40	Bianco White	8998	20	120
	Cromato brillante Chrome plated	4491	20	120
	Ottonato verniciato Brass plated varnished	4492	20	120
	Nichel spazzolato Brushed nickel	5732	20	120
50	Bianco White	8999	20	80
	Cromato brillante Chrome plated	6455	20	80
	Ottonato verniciato Brass plated varnished	6454	20	80
	Nichel spazzolato Brushed nickel	6457	20	80

Catenaccio mod. 950 Barrel bolt mod. 950

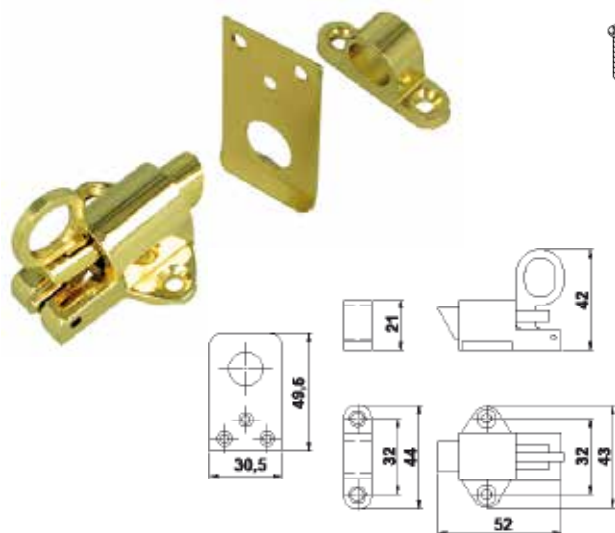

Misure mm
Sizes mm.

43 x 52

Finitura
Finish

Nichel spazzolato
Brushed nickel plated
Ottonato verniciato
Brass plated varnished

Cod.



10619	20	200
10620	20	200

Catenaccio mod. 960 Barrel bolt mod. 960

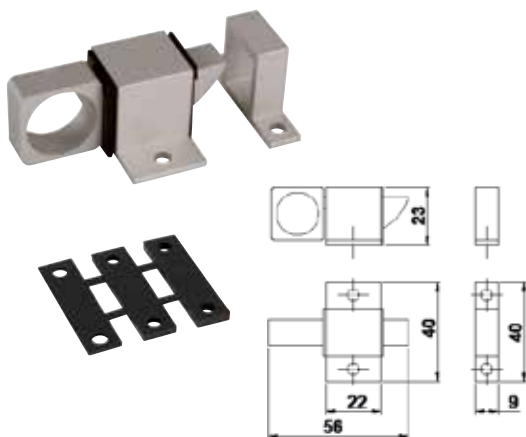

Finitura
Finish

Cod.



Alluminio laccato bianco <i>White painted aluminium</i>	10837	10	100
Alluminio anodizzato oro <i>Gold anodized aluminium</i>	10835	10	100
Alluminio anodizzato argento <i>Silver anodized aluminium</i>	10834	10	100

Catenaccio mod. 368 Barrel bolt mod. 368

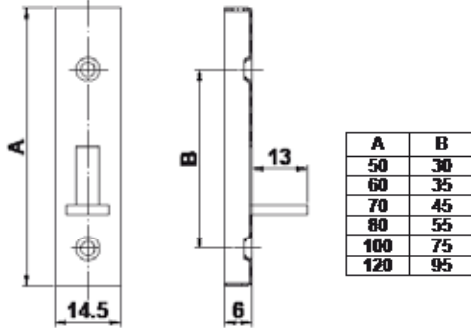
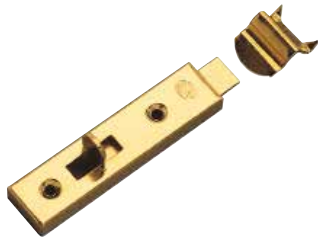

Finitura Finish	Misure mm Sizes mm.	Cod.		
Ottonato verniciato Brass plated varnished	60	212	50	500
	80	216	50	500
	100	218	50	500
Nichelato Nickel plated	60	211	50	500
	80	215	50	500
	100	217	50	500

Catenaccio mod. 425 Barrel bolt mod. 425

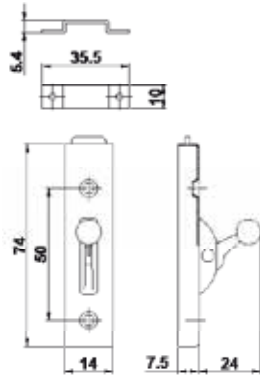

Misure mm Sizes mm.	Finitura Finish	Cod.		
75	Ottonato verniciato Brass plated varnished	309	50	500
	Nichelato Nickel plated	310	50	500

Catenaccio mod. 600 Barrel bolt mod. 600

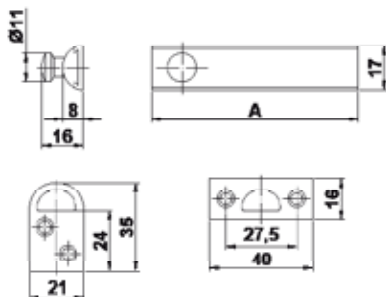

Finitura Finish	Misure mm (A) Sizes mm.	Cod.		
Ottone cuoio Antique brass	60	6384	20	200
	80	6385	20	200
	100	6386	20	200
Ottone lucido verniciato Solid brass varnished	60	3184	20	200
	80	3185	20	200
	100	3186	20	200